

1. **NOTES:**
- 2.
3. PRIVATE ROAD MAINTENANCE BY "THE ISLAND" TRACT OWNERS
WATER SUPPLIED BY INDIVIDUAL DOMESTIC WELLS
4. SEWER DISPOSAL BY INDIVIDUAL SEPTIC SYSTEMS
5. ACCESS AND UTILITY EASEMENTS AS SHOWN ON RECORD OF SURVEY
TO BE GRANTED AND RESERVED ON DEEDS FOR EACH TRACT.
6. DECLARATIONS OF COVENANTS ARE RECORDED BY SEPARATE
DOCUMENT.
7. INTERIOR LOT LINES 30' UTILITY EASEMENT 15' EACH SIDE OF
PROPERTY LINE. EXTERIOR BOUNDARY HAS 30' UTILITY EASEMENT
ALL ROOMS ARE 60' ACCESS AND UTILITY EASEMENTS AS SHOWN ON
RECORD OF SURVEY TO BE GRANTED AND RESERVED ON DEEDS FOR
EACH TRACT
8. PROPERTY COVENANTS ARE SET ON CENTERLINE OF ACCESS EASEMENT
9. W/OUT RIGHT-OF-WAY REVEALED DOCUMENTS FOR HIGHWAY #712
10. PROJECT NUMBER RS-068-90 DATED 5/6/87

LEGAL DESCRIPTION:

A PARCEL OF LAND LOCATED IN A PORTION OF SECTIONS 4 & 5, TOWNSHIP 57 NORTH, RANGE 63 WEST, AND SECTION 28, 32 & 33 TOWNSHIP 58 NORTH, RANGE 63 WEST OF THE SIXTH PRINCIPAL MERIDIAN, CROOK COUNTY, WYOMING, BEING MORE PARTICULARLY DESCRIBED AS FOLLOWS:

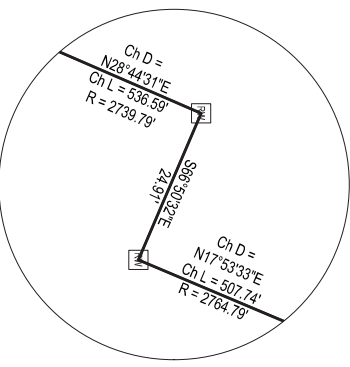
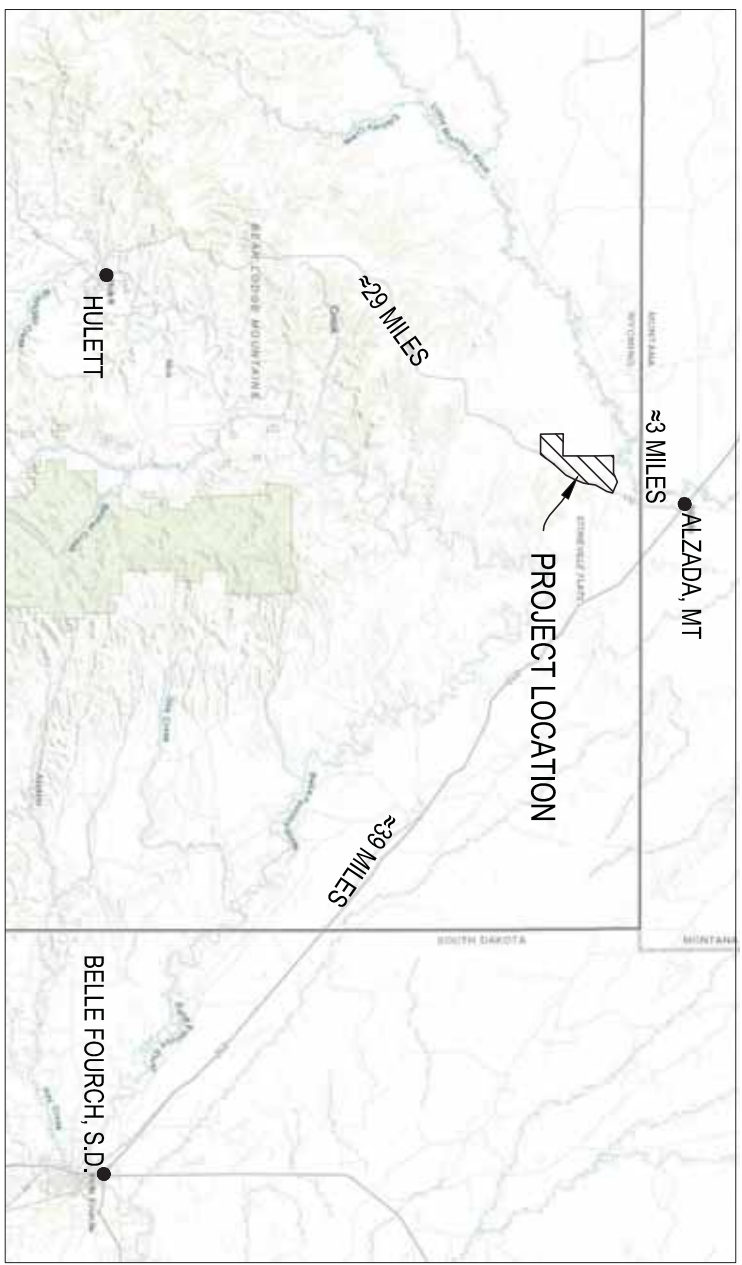

INSET 'A'

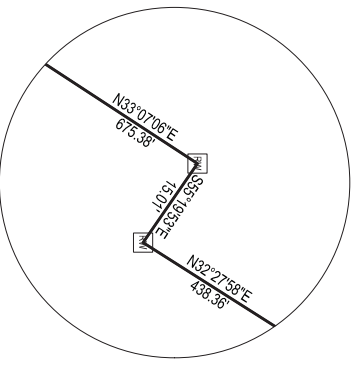

INSET 'B'

CERTIFICATE OF SURVEYOR:

I, ADAM E. DESCHLER, A REGISTERED PROFESSIONAL LAND SURVEYOR IN THE STATE OF WYOMING, DO HEREBY STATE THAT THIS MAP OF SURVEY WAS PREPARED FROM FIELD NOTES TAKEN DURING AN ACTUAL SURVEY MADE BY ME OR UNDER MY DIRECT SUPERVISION COMPLETED IN MAY 2022, AND THAT TO THE BEST OF MY KNOWLEDGE, INFORMATION AND BELIEF THIS MAP CORRECTLY SHOWS THE RESULTS OF SAID SURVEY AND THAT THE MONUMENTS FOUND OR SET ARE AS SHOWN.

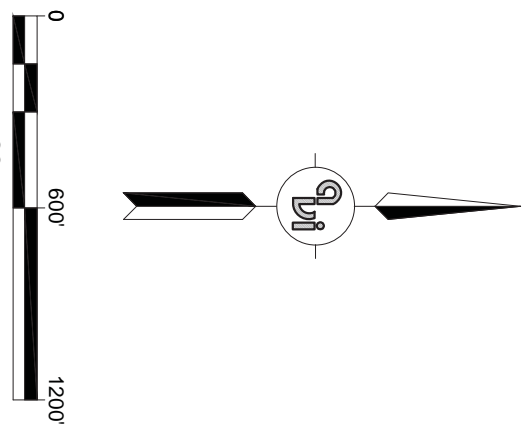
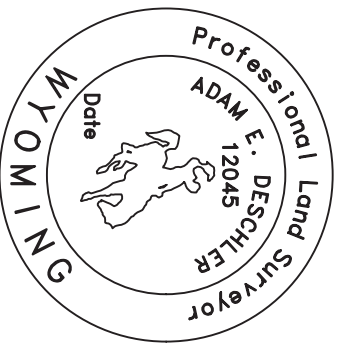

FILING RECORD

RECORD OF SURVEY

INCLUDES A PORTION OF SECTIONS 4, AND 5
T. 57 N., R. 63 W., AND PORTIONS OF
SECTIONS 28, 32 AND 33 T. 58 N., R. 63 W.,

CROOK COUNTY WYOMING
PREPARED JULY 2022

NO.	REVISION	DATE

PREPARED FOR:

PRONGHORN CONSTRUCTION Ltd. Keogh
P.O. BOX 2215
CHEYENNE, WY. 82003
307-632-2967

PROJECT:

PINE ISLAND DEVELOPMENT

DRAWING TITLE:

RECORD OF SURVEY



307.637.6017
1103 OLD TOWN LANE, SUITE 101
CHEYENNE, WY 82009
AVI@AVIPC.COM

DATE: _____

CMC

DESIGNED BY: CMC

CHECKED BY: AED/BHP

2-4630 22

→

Of 1